

VAU/DE

VALVOLA ANTIURTO DOPPIA
DUAL CROSS-OVER RELIEF VALVE
SCHOCKVENTIL DOPPELWIRKEND

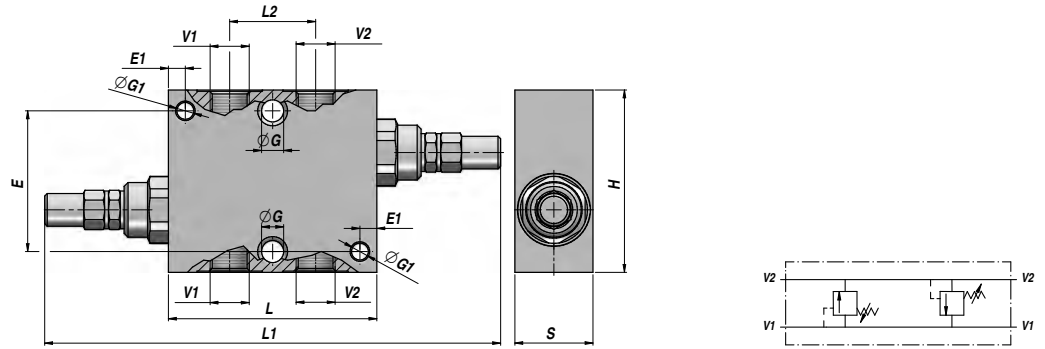
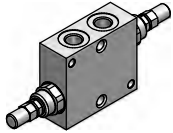

Codice Code Bestell-Nr.	V1 BSP	V2 BSP	Q MAX l/min	P MAX bar	Tipo Type Typ	L	L1	L2	ØG	E	ØG1	E1	H	S	kg
V0590.0438	1/4"	1/4"	30	300	VAU/DE 1/4" C	60	158	26	-	-	6,5	6,5	70	30	0,99
V0590.0440	3/8"	3/8"	45	300	VAU/DE 3/8" C	80	178	33	8,5	54	-	-	70	30	1,21
V0590.0450	1/2"	1/2"	70	300	VAU/DE 1/2" C	80	204	38	8,5	54	-	-	70	30	1,15
V0590.0460	3/4"	3/4"	110	300	VAU/DE 3/4" C	95	219	44	8,5	54	-	-	80	35	1,68

MOLLA - SPRING - FEDER: A = 10:50 bar - B = 20:100 bar - C = 10:180 bar (Standard) - D = 50:250 bar - E = 80:300 bar

MONTAGGIO IN LINEA
LINE MOUNTING
REIHENMONTAGE

MATERIALE - MATERIAL: ACCIAIO - STEEL - STAHL

VAU/DE 1"

VALVOLA ANTIURTO DOPPIA (PILOTATA)
DUAL CROSS-OVER RELIEF VALVE (PILOT OPERATED)
SCHOCKVENTIL DOPPELWIRKEND (VORGESTEUERTE BETÄTIGUNG)

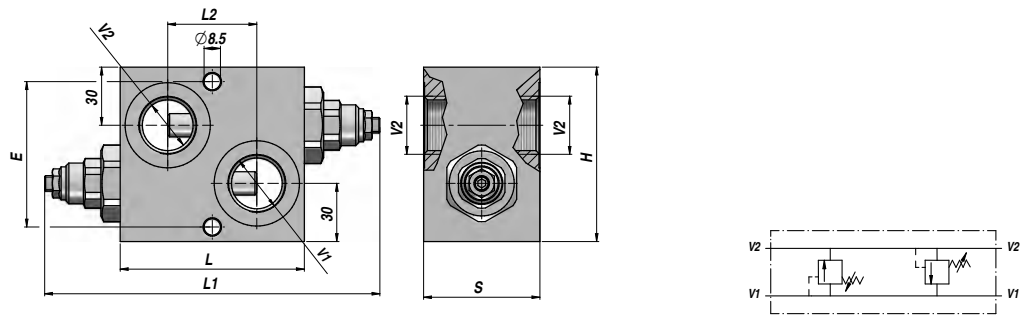
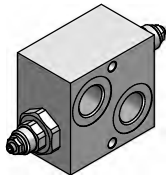

Codice Code Bestell-Nr.	V1 BSP	V2 BSP	Q MAX l/min	P MAX bar	Tipo Type Typ	L	L1	L2	E	H	S	kg
V0590.0470	1"	1"	160	350	VAU/DE 1" Q	95	177	46	75	90	60	3,20

MOLLA - SPRING - FEDER: N = 20:200 bar - Q = 50:400 bar (Standard)

MONTAGGIO IN LINEA
LINE MOUNTING
REIHENMONTAGE

MATERIALE - MATERIAL: ACCIAIO - STEEL - STAHL