

STRAIGHT BS5200/DIN 3852 ADAPTOR
Thread BSP Parallel

Type: 3005..

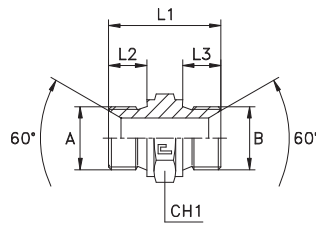

Series BS	30.... bar	31.... bar	Ordering Complete	A	B	L1	L2	L3	CH1
UNIVERSAL	400	400	300501	1/8	1/8	24	8	8	14
			300502	1/8	1/4	28,5	8	11	19
			300503	1/8	3/8	30	8	12	22
			300504	1/4	1/4	32	11	11	19
			300505	1/4	3/8	33,5	11	12	22
	350	350	300506	1/4	1/2	37	11	14	27
	315	315	300507	1/4	3/4	41	11	16	32
	400	400	300508	3/8	3/8	35	12	12	22
	350	350	300509	3/8	1/2	38,5	12	14	27
	315	315	300510	3/8	3/4	42,5	12	16	32
	350	350	300511	1/2	1/2	41	14	14	27
			300512	1/2	5/8	43	14	16	30
	315	315	300513	1/2	3/4	45	14	16	32
	250	250	300514	1/2	1	49	14	19	41
	200	200	300515	1/2	1 1/4	52	14	20	50
	350	350	300516	5/8	5/8	45	16	16	30
	315	315	300517	5/8	3/4	47	16	16	32
			300518	3/4	3/4	47	16	16	32
	250	250	300519	3/4	1	51	16	19	41
	200	200	300520	3/4	1 1/4	54	16	20	50
	160	160	300521	3/4	1 1/2	59	16	23	55
	250	250	300522	1	1	54	19	19	41
	200	200	300523	1	1 1/4	57	19	20	50
	160	160	300524	1	1 1/2	62	19	23	55
	125	125	300525	1	2	67,5	19	25	70
	200	200	300526	1 1/4	1 1/4	58	20	20	50
	160	160	300527	1 1/4	1 1/2	63	20	23	55
	125	125	300528	1 1/4	2	68,5	20	25	70
	160	160	300529	1 1/2	1 1/2	66	23	23	55
	125	125	300530	1 1/2	2	71,5	23	25	70
			300531	2	2	74	25	25	70
	350	350	300532	1/8	1/2	33,5	8	14	27
			300533	1/4	5/8	39	11	16	30
	250	250	300534	1/4	1	45	11	19	41
	350	350	300535	3/8	5/8	40,5	12	16	30
	250	250	300536	3/8	1	46,5	12	19	41
	160	160	300537	1/2	1 1/2	57	14	23	55
	250	250	300538	5/8	1	51	16	19	41
	200	200	300539	5/8	1 1/4	54	16	20	50

Notes: If you wish to order a fitting in stainless steel, please change the first two digit from 30.... to 31....
For copper washer sealing systems refer to items 3001.. pressure rates

STRAIGHT ISO 8434/6 COMPACT ADAPTOR TABLE 10 FIG. 9
Thread BSP Parallel

Type: 3005..

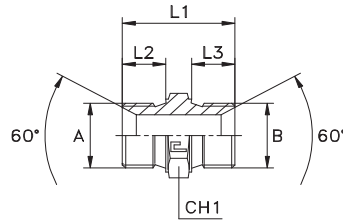

Serie BS	30.... bar	31.... bar	Ordering Complete	A	B	L1	L2	L3	CH1
UNIVERSAL	400	400	300551	1/8	1/8	21	8	8	12
			300552	1/8	1/4	27	8	11	17
			300553	1/8	3/8	29	8	12	19
			300554	1/4	1/4	28,5	11	11	17
			300555	1/4	3/8	30,5	11	12	19
	350	350	300556	1/4	1/2	34,5	11	14	24
	315	315	300557	1/4	3/4	37,5	11	16	30
	400	400	300558	3/8	3/8	32	12	12	19
	350	350	300559	3/8	1/2	36	12	14	24
	315	315	300560	3/8	3/4	39	12	16	30
	350	350	300561	1/2	1/2	37	14	14	24
			300562	1/2	5/8	39,5	14	16	27
	315	315	300563	1/2	3/4	40,5	14	16	30
	250	250	300564	1/2	1	44,5	14	19	36
	200	200	300565	1/2	1 1/4	50	14	20	46
	350	350	300566	5/8	5/8	43	16	16	27
			300567	5/8	3/4	44	16	16	30
	315	315	300568	3/4	3/4	42,5	16	16	30
			300569	3/4	1	46,5	16	19	36
	250	250	300570	3/4	1 1/4	52	16	20	46
	160	160	300571	3/4	1 1/2	55,5	16	22	50
	250	250	300572	1	1	49	19	19	36
	200	200	300573	1	1 1/4	55	19	20	46
	160	160	300574	1	1 1/2	58,5	19	22	50
	125	125	300575	1	2	63,5	19	25	65
	200	200	300576	1 1/4	1 1/4	56	20	20	46
	160	160	300577	1 1/4	1 1/2	59,5	20	22	50
	125	125	300578	1 1/4	2	65	20	25	65
	160	160	300579	1 1/2	1 1/2	61,5	22	22	50
	125	125	300580	1 1/2	2	67,5	22	25	65
			300581	2	2	70	25	25	65
	350	350	300582	1/8	1/2	33	8	14	24
			300583	1/4	5/8	37,5	11	16	27
250	250	300584	1/4	1	42	11	19	36	
350	350	300585	3/8	5/8	38,5	12	16	27	
250	250	300586	3/8	1	43,5	12	19	36	
160	160	300587	1/2	1 1/2	53,5	14	22	50	
250	250	300588	5/8	1	48,5	16	19	36	
200	200	300589	5/8	1 1/4	54	16	20	46	

Notes: If you wish to order a fitting in stainless steel, please change the first two digit from 30.... to 31....
For copper washer sealing systems refer to items 3001.. pressure rates