



## Solenoid valve 2/2 way N.C. Direct acting

21JPBR0V12

÷

21JPBR0V23

### PRESENTATION:

Direct acting S.V. for interception of fluids compatible with the construction materials.

Minimum operational pressure is not required.

The materials used and the tests carried out ensure maximum reliability and duration.

**USE:** Automation, Sterilization  
Vending

**PIPES:** Plug in connection

**COIL:** 2,5W - Ø 10  
LBA 155°C (class F)  
5W - Ø 10  
LBA 155°C (class F)  
LBF - LBV 180°C (class H)

**COIL HOUSING AND COIL FORMER MATERIAL ARE  
MADE BY 100% VIRGIN MATERIAL.**

Max. allowable pressure (PS) 16 bar

Ambient temperature:

See coils catalogue page for its compatibility.



Gaskets	Temperature		Medium
V=FKM (fluoroelastomer)	- 10°C	+ 140°C	Air, water, inert gas, steam

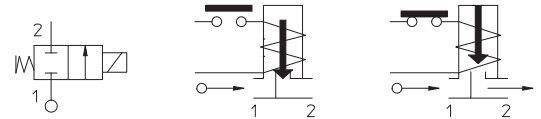

Pipe	Code	Max viscosity		Ø  mm	Kv	Power	Pressure		
		cSt	°E				min	M.O.P.D.	
					bar	AC bar	DC bar		
Plug in connection	21JPBR0V12	12	~ 2	1,2	1	2,5	0	15	3,5
						5			12
	21JPBR0V23	37	~ 5	2,3	2,1	2,5		6	-
						5		15	8

### Note

Coil nut assembly 2 Nm max, armature tube 4 Nm | Available with coil Ex nA | The use of rigid sealings (Ruby or PTFE) usually implies a slight leakage, limited within 2scc/min at the pressure of 1 bar | For application with steam or with PS above the 16 bar, please consult our Technical Service | Available on request and with minimum quantities..

The "ODE" reserves the right to carry out technical and aesthetic modifications without prior notice

## MATERIALS:

**Body**

PPS

**Armature tube**

Stainless steel AISI series 300

**Fixed core**

Stainless steel AISI series 400

**Plunger**

Stainless steel AISI series 400

**Phase displacement ring**

Gold plated copper

**Spring**

Stainless steel AISI series 300

**Seal**

V=FKM

**Orifice**

PPS

**On request:**

**Connector**

Pg 9 or Pg 11

**Connector conformity**

ISO 4400

## FEATURES:

**Electrical conformity**

IEC 335

**Protection degree**

IP 65 EN 60529 (DIN 40050)  
with coil fitted by connector.

## SPARE PARTS:

### 1. Coil:

See coils list

## ACCESSORIES:

Tube (int.Ø 2 mm; ext.Ø 4mm)  
for fast fitting

Code R453130/

Tube with male fitting

Code R453154/

Tube with double male fitting

(see catalogue page)

## DIMENSIONS:

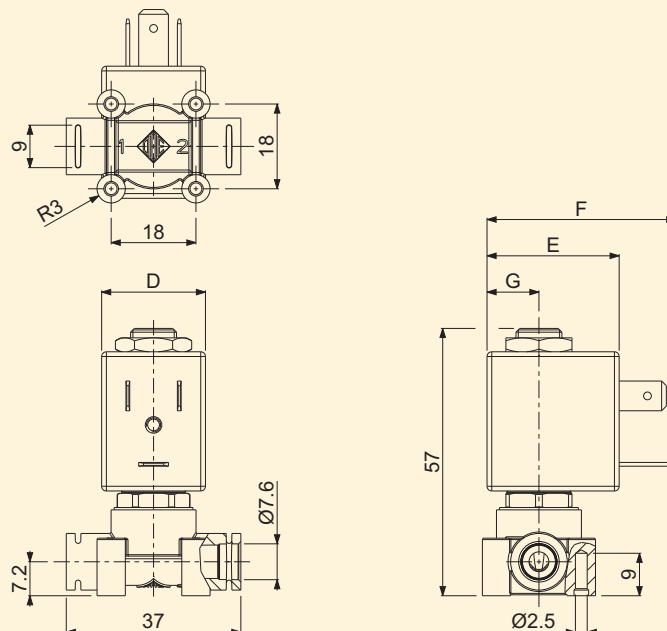

COIL TYPE	POWER ABSORPTION			DIMENSIONS			
	W ==	Hold VA ~	Inrush VA ~	D mm	E mm	F mm	G mm
L	2,5	5	7	22	27,5	39,5	11
	5	10	15				