

MALE STUD ELBOW 45°
Thread BSP Taper - Thread NPTF

Type: 2012...3
Type: 2013...3

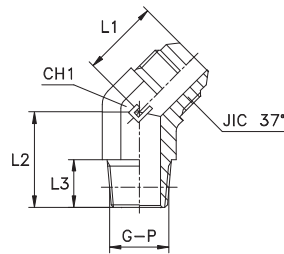

Series JIC	20.... bar	21.... bar	Ordering Complete	Ø Tube M	Ø Tube W	G	L1	L2	L3	CH1	JIC 37°		
UNIVERSAL	350	350	201201.3	6	1/4	1/8	19,5	16,5	10	11	7/16-20		
			201202.3	8	5/16	1/8	20	16,5	10	14	1/2-20		
			201203.3	10	3/8	1/4	21,5	22	14,5	14	9/16-18		
			201204.3	12	1/2	3/8	25,5	24	14,5	19	3/4-16		
			201205.3	14-15-16	5/8	1/2	29	29,5	19	22	7/8-14		
			201206.3	18-20	3/4	3/4	33	30,5	19	27	1 1/16-12		
	290	290	201207.3	25	1	1	38	38	24	33	15/16-12		
			201208.3	30-32	1 1/4	1 1/4	40	42	25	41	15/8-12		
	240	240	201209.3	38	1 1/2	1 1/2	46	45	26	48	17/8-12		
			201210.3	6	1/4	1/4	20	22	14,5	14	7/16-20		
	350	350	201211.3	8	5/16	1/4	20	22	14,5	14	1/2-20		
			201212.3	10	3/8	1/8	21,5	16,5	10	14	9/16-18		
			201213.3	10	3/8	3/8	23	24	14,5	19	9/16-18		
			201214.3	10	3/8	1/2	23,5	29,5	19	22	9/16-18		
			201215.3	12	1/2	1/4	25,5	24	14,5	19	3/4-16		
			201216.3	12	1/2	1/2	26	29,5	19	22	3/4-16		
			201217.3	12	1/2	3/4	27	30,5	19	27	3/4-16		
			201218.3	14-15-16	5/8	3/8	29	25,5	14,5	22	7/8-14		
			201219.3	14-15-16	5/8	3/4	30	30,5	19	27	7/8-14		
			201220.3	18-20	3/4	1/2	33	30,5	19	27	1 1/16-12		
			290	290	201221.3	18-20	3/4	1	37	38	24	33	1 1/16-12
					201222.3	25	1	3/4	38	33	19	33	15/16-12
	240	240	201223.3	30-32	1 1/4	1	40	41	24	41	15/8-12		

Notes: If you wish to order a fitting in stainless steel, please change the first two digit from 20.... to 21....
Articles available on scheduled orders only.

Series JIC	20.... bar	21.... bar	Ordering Complete	Ø Tube M	Ø Tube W	P	L1	L2	L3	CH1	JIC 37°		
UNIVERSAL	350	350	201301.3	6	1/4	1/8	19,5	16,5	10	11	7/16-20		
			201302.3	8	5/16	1/8	20	16,5	10	14	1/2-20		
			201303.3	10	3/8	1/4	21,5	22	14,5	14	9/16-18		
			201304.3	12	1/2	3/8	25,5	24	14,5	19	3/4-16		
			201305.3	14-15-16	5/8	1/2	29	29,5	19	22	7/8-14		
			201306.3	18-20	3/4	3/4	33	30,5	19	27	1 1/16-12		
	290	290	201307.3	25	1	1	38	38	24	33	15/16-12		
			201308.3	30-32	1 1/4	1 1/4	40	42	25	41	15/8-12		
	240	240	201309.3	38	1 1/2	1 1/2	46	45	26	48	17/8-12		
			201310.3	6	1/4	1/4	20	22	14,5	14	7/16-20		
	350	350	201311.3	8	5/16	1/4	20	22	14,5	14	1/2-20		
			201312.3	10	3/8	1/8	21,5	16,5	10	14	9/16-18		
			201313.3	10	3/8	3/8	23	24	14,5	19	9/16-18		
			201314.3	10	3/8	1/2	23,5	29,5	19	22	9/16-18		
			201315.3	12	1/2	1/4	25,5	24	14,5	19	3/4-16		
			201316.3	12	1/2	1/2	26	29,5	19	22	3/4-16		
			201317.3	12	1/2	3/4	27	30,5	19	27	3/4-16		
			201318.3	14-15-16	5/8	3/8	29	25,5	14,5	22	7/8-14		
			201319.3	14-15-16	5/8	3/4	30	30,5	19	27	7/8-14		
			201320.3	18-20	3/4	1/2	33	30,5	19	27	1 1/16-12		
			290	290	201321.3	18-20	3/4	1	37	38	24	33	1 1/16-12
					201322.3	25	1	3/4	38	33	19	33	15/16-12
	240	240	201323.3	30-32	1 1/4	1	40	41	24	41	15/8-12		

Notes: If you wish to order a fitting in stainless steel, please change the first two digit from 20.... to 21....
Articles available on scheduled orders only.