

STRAIGHT REDUCING COUPLING

Type: 1041...1 Body

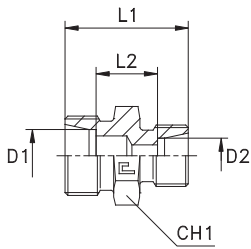

Type: 1041.. B3 Ring

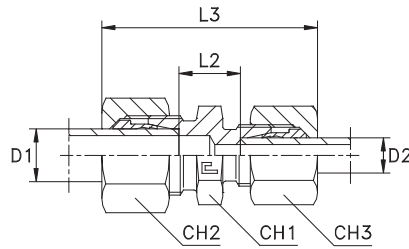

Type: 1041...4 B4 Ring

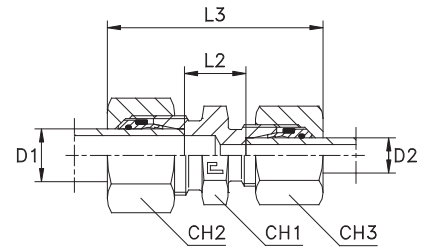

Series DIN	10.... bar	11.... bar	Ordering Body	Ordering Equipped B3	Ø Tube		L1	L2	L3	CH1	CH2	CH3	Ordering Equipped B4
					D1	D2							
L	500	315	104104.1	104104	8	6	25	11	40,5	14	17	14	104104.4
			104105.1	104105	10	6	26	12	41,5	17	19	14	104105.4
			104106.1	104106	10	8	26	12	42	17	19	17	104106.4
	104107.1		104107	12	6	27	13	42	19	22	14	104107.4	
	104108.1		104108	12	8	27	13	42,5	19	22	17	104108.4	
	104109.1		104109	12	10	28	14	43,5	19	22	19	104109.4	
	104110.1		104110	15	10	29	15	45	24	27	19	104110.4	
	104111.1		104111	15	12	29	15	44,5	24	27	22	104111.4	
	104112.1		104112	18	10	30	15,5	47	27	32	19	104112.4	
	104113.1		104113	18	12	30	15,5	46,5	27	32	22	104113.4	
	104114.1		104114	18	15	31	16,5	48	27	32	27	104114.4	
	104115.1		104115	22	12	32	17,5	48,5	32	36	22	104115.4	
	104116.1		104116	22	15	33	18,5	50	32	36	27	104116.4	
	104117.1		104117	22	18	33	18	51	32	36	32	104117.4	
104118.1	104118	28	18	34	19	52	41	41	32	104118.4			
104119.1	104119	28	22	36	21	54	41	41	36	104119.4			
104120.1	104120	35	22	39	21	59	46	50	36	104120.4			
104121.1	104121	35	28	39	21	59	46	50	41	104121.4			
S	800	630	104122.1	104122	8	6	32	18	48	17	19	17	104122.4
			104123.1	104123	10	6	32	17,5	48,5	19	22	17	104123.4
			104124.1	104124	10	8	32	17,5	48,5	19	22	19	104124.4
	104125.1		104125	12	6	34	19,5	50,5	22	24	17	104125.4	
	104126.1		104126	12	8	34	19,5	50,5	22	24	19	104126.4	
	104127.1		104127	12	10	34	19	51	22	24	22	104127.4	
	104128.1		104128	14	10	36	20,5	54,5	24	27	22	104128.4	
	104129.1		104129	14	12	36	20,5	54,5	24	27	24	104129.4	
	104130.1		104130	16	12	36	20	54,5	27	30	24	104130.4	
	104131.1		104131	16	14	38	21,5	58	27	30	27	104131.4	
	104132.1		104132	20	10	40	22	59,5	32	36	22	104132.4	
	104133.1		104133	20	12	40	22	59,5	32	36	24	104133.4	
	104134.1		104134	20	16	42	23	63	32	36	30	104134.4	
	104135.1		104135	25	16	46	25,5	68	41	46	30	104135.4	
	104136.1		104136	25	20	48	25,5	71	41	46	36	104136.4	
	104137.1		104137	30	20	50	26	74	46	50	36	104137.4	
	104138.1		104138	30	25	52	26,5	77	46	50	46	104138.4	
104139.1	104139	38	30	59	29,5	87	55	60	50	104139.4			

Note: If you wish to order AISI 316 stainless steel fittings, please change the first two digits from 10.... to 11....
 If you wish to order AISI 316 stainless steel fittings with AISI 304 stainless steel nuts, please change the first two digits from 10.... to 14....
 Items not included in the ISO 8434-1 Norm available on scheduled orders only