

# VGS™5010,



- Patented COAX® technology.
- The suction cups are specially designed for handling larger parts, such as car body sheets.
- Compatible with any suction cup with G1/2" male fitting. Suction cup ordered separately.
- Available with a two or three-stage COAX® cartridge MIDI. Choose an Si cartridge for extra vacuum flow, a Pi cartridge for high performance at low feed pressure or an Xi cartridge when high flow and deep vacuum is needed.
- The three-stage cartridge will give extra high initial vacuum flow, suitable in high speed applications.
- Easy installation and flexible positioning with several mounting options.

## General

|             |                           |
|-------------|---------------------------|
| Material    | PA, SS, Al, Nitrile (NBR) |
| Noise level | 73 – 83 dBA               |
| Temperature | -10 – 80 °C               |

## Performance

|                     |         |
|---------------------|---------|
| Feed pressure, max. | 0.7 MPa |
|---------------------|---------|

## Vacuum flow

| COAX® Cartridge | Feed pressure<br>MPa | Air consumption<br>NI/s | Vacuum flow (NI/s) at different vacuum levels (-kPa) |     |     |     |      |      |      |      |      |      |    | Max vacuum<br>-kPa |
|-----------------|----------------------|-------------------------|--|-----|-----|-----|------|------|------|------|------|------|----|--------------------|
|                 |                      |                         | 0  | 10  | 20  | 30  | 40   | 50   | 60   | 70   | 80   | 90   |    |                    |
| Pi48-2          | 0.31                 | 2                       | 2.8  | 2.5 | 1.8 | 1.1 | 0.65 | 0.5  | 0.35 | 0.25 | 0.1  | —    | 90 |                    |
| Pi48-3          | 0.31                 | 2.05                    | 5.6  | 2.5 | 1.8 | 1.1 | 0.65 | 0.5  | 0.35 | 0.25 | 0.1  | —    | 90 |                    |
| Si32-2          | 0.6                  | 1.75                    | 3.3  | 3   | 2.6 | 1.7 | 0.9  | 0.6  | 0.5  | 0.35 | —    | —    | 75 |                    |
| Si32-3          | 0.6                  | 1.75                    | 6  | 3.5 | 2.6 | 1.7 | 0.9  | 0.6  | 0.5  | 0.35 | —    | —    | 75 |                    |
| Xi40-2          | 0.45                 | 1.83                    | 2.8  | 2.3 | 1.6 | 1   | 0.73 | 0.58 | 0.43 | 0.32 | 0.18 | 0.03 | 95 |                    |
| Xi40-3          | 0.45                 | 1.83                    | 5.9  | 3   | 2   | 1.3 | 0.73 | 0.58 | 0.43 | 0.32 | 0.18 | 0.03 | 95 |                    |

## Evacuation time

| COAX® Cartridge | Feed pressure<br>MPa | Air consumption<br>NI/s | Evacuation time (s/l) to reach different vacuum levels (-kPa) |       |      |      |      |      |      |     |     |    |  | Max vacuum<br>-kPa |
|-----------------|----------------------|-------------------------|---|-------|------|------|------|------|------|-----|-----|----|--|--------------------|
|                 |                      |                         | 10  | 20    | 30   | 40   | 50   | 60   | 70   | 80  | 90  |    |  |                    |
| Pi48-2          | 0.31                 | 2                       | 0.03  | 0.07  | 0.13 | 0.26 | 0.46 | 0.7  | 1    | 1.6 | 4   | 90 |  |                    |
| Pi48-3          | 0.31                 | 2.05                    | 0.02  | 0.06  | 0.12 | 0.25 | 0.45 | 0.7  | 1    | 1.6 | 4   | 90 |  |                    |
| Si32-2          | 0.6                  | 1.75                    | 0.03  | 0.07  | 0.1  | 0.18 | 0.33 | 0.53 | 0.8  | —   | —   | 75 |  |                    |
| Si32-3          | 0.6                  | 1.75                    | 0.02  | 0.05  | 0.1  | 0.18 | 0.33 | 0.53 | 0.8  | —   | —   | 75 |  |                    |
| Xi40-2          | 0.45                 | 1.83                    | 0.04  | 0.09  | 0.17 | 0.28 | 0.44 | 0.63 | 0.9  | 1.3 | 2.3 | 95 |  |                    |
| Xi40-3          | 0.45                 | 1.83                    | 0.022   | 0.062 | 0.12 | 0.22 | 0.37 | 0.57 | 0.84 | 1.2 | 2.2 | 95 |  |                    |

## Blow flow

| COAX® Cartridge | Feed pressure<br>MPa | Air consumption<br>NI/s | Blow flow (NI/s) at different pressure levels (kPa) |      |      |      |     |      |      |      |      |    |  | Max pressure<br>kPa |
|-----------------|----------------------|-------------------------|---|------|------|------|-----|------|------|------|------|----|--|---------------------|
|                 |                      |                         | 0   | 10   | 20   | 30   | 40  | 50   | 60   | 70   | 80   |    |  |                     |
| Si32-2          | 0.6                  | 1.75                    | 5.05  | 4.83 | 4.25 | 3.61 | 3.3 | 2.89 | 2.65 | 2.35 | 1.97 | 80 |  |                     |
| Si32-3          | 0.6                  | 1.75                    | 7.8   | 5.4  | 4.6  | 3.8  | 3.3 | 3.1  | 2.7  | 2.3  | 1.8  | 80 |  |                     |

## Dimensional drawings

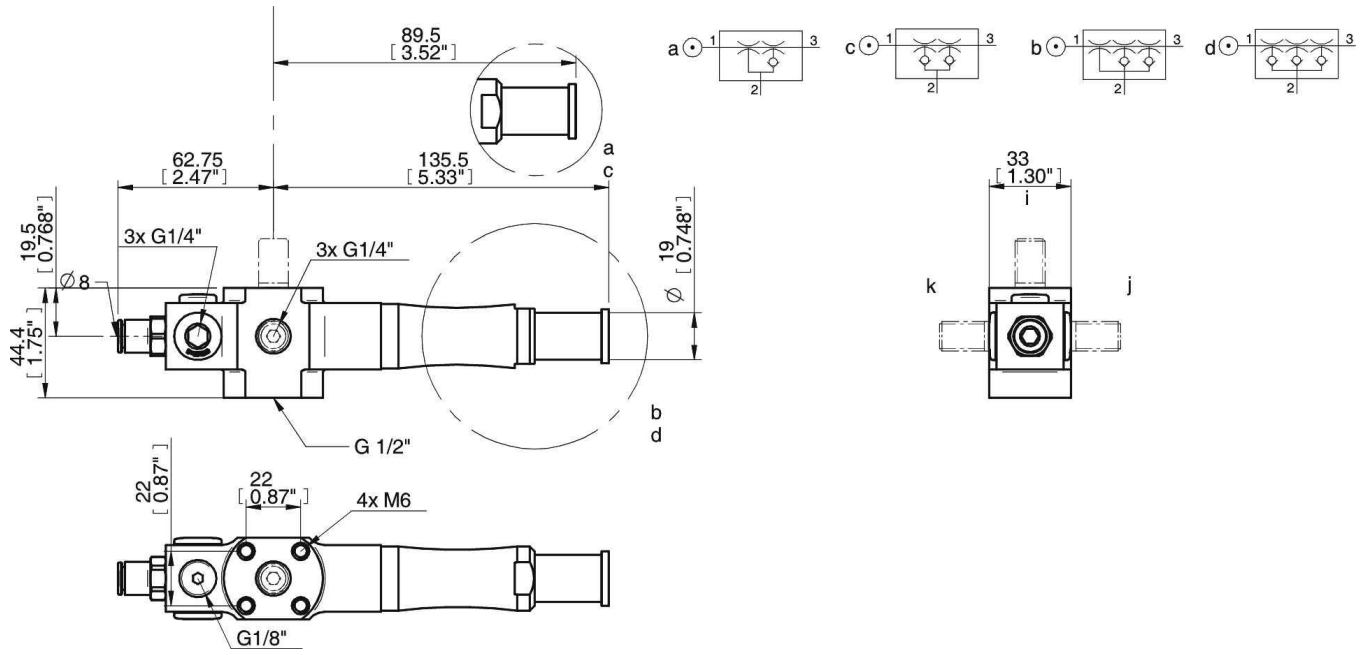

Values specified in the data sheet are tested at:

|                        |  |
|------------------------|--|
| Room temperature       | (20°C [68°F] ± 3°C [5.5°F])              |
| Standard atmosphere    | (101.3 [29.9 inHg] ± 1.0 kPa [0.3 inHg]) |
| Relative humidity      | 0-100%                                   |
| Compressed air quality | DIN ISO 8573-1 class 4                   |