

FEMALE STRAIGHT ADAPTER Thread BSP Taper

Type: 3014..

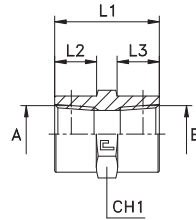

Series BS	30... bar	31... bar	Ordering Complete	A	B	L1	L2	L3	CH1
UNIVERSAL	350	350	301401	1/8	1/8	20	7	7	14
			301402	1/4	1/4	30	12	12	19
	250	250	301403	3/8	3/8	30	12	12	24
	225	225	301404	1/2	1/2	38	15	15	27
	200	200	301405	3/4	3/4	40	15	15	36
			301406	1	1	48	19	19	41
			301407	1 1/4	1 1/4	60	24	24	50
	160	160	301408	1 1/2	1 1/2	60	23	23	60
			301409	1/8	1/4	25	7	12	19
	350	350	301410	1/8	3/8	25	7	12	24
			301411	1/4	3/8	30	12	12	24
	225	225	301412	1/4	1/2	35	12	15	27
	200	200	301413	1/4	3/4	37	12	15	36
	225	225	301414	3/8	1/2	35	12	15	27
	200	200	301415	1/2	3/4	40	15	15	36

Notes: If you wish to order a fitting in stainless steel, please change the first two digit from 30.... to 31....
Articles available on scheduled orders only.

FEMALE STRAIGHT ADAPTER Thread NPT

Type: 3015..

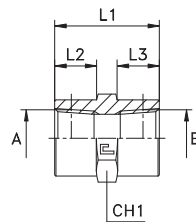

Series BS	30... bar	31... bar	Ordering Complete	A	B	L1	L2	L3	CH1
UNIVERSAL	350	350	301501	1/8	1/8	20	7	7	14
			301502	1/4	1/4	30	12	12	19
	250	250	301503	3/8	3/8	30	12	12	24
	225	225	301504	1/2	1/2	38	15	15	27
	200	200	301505	3/4	3/4	40	15	15	36
			301506	1	1	48	19	19	41
			301507	1 1/4	1 1/4	60	24	24	50
	160	160	301508	1 1/2	1 1/2	60	23	23	60
			301509	1/8	1/4	25	7	12	19
	350	350	301510	1/8	3/8	25	7	12	24
			301511	1/4	3/8	30	12	12	24
	225	225	301512	1/4	1/2	35	12	15	27
	200	200	301513	1/4	3/4	37	12	15	36
	225	225	301514	3/8	1/2	35	12	15	27
	200	200	301515	1/2	3/4	40	15	15	36

Notes: If you wish to order a fitting in stainless steel, please change the first two digit from 30.... to 31....
Articles available on scheduled orders only.