

MALE STUD ELBOW
Thread NPT - Thread Metric Taper

Type: 1021...1 Body
Type: 1022...1 Body

Type: 1021.. B3 Ring
Type: 1022.. B3 Ring

Type: 1021...4 B4 Ring
Type: 1022...4 B4 Ring

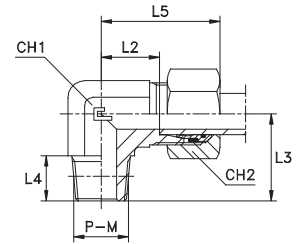
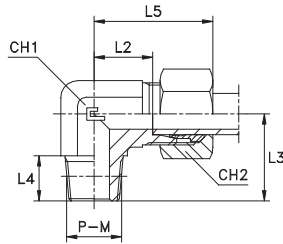
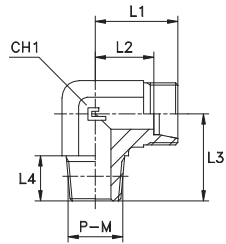

Series DIN	10.... bar	11.... bar	Ordering Body	Ordering Equipped B3	Ø Tube	P	L1	L2	L3	L4	L5	CH1	CH2	Ordering Equipped B4
L	315	315	102104.1	102104	6	1/8	19	12	20	10	27	12	14	102104.4
			102105.1	102105	8	1/4	21	14	26	15	29	12	17	102105.4
			102106.1	102106	10	1/4	22	15	27	15	30	14	19	102106.4
			102107.1	102107	12	3/8	24	17	28	15	32	17	22	102107.4
			102108.1	102108	15	1/2	28	21	34	19.5	36	19	27	102108.4
			102109.1	102109	18	1/2	31	23.5	36	19.5	40	24	32	102109.4
	160	160	102110.1	102110	22	3/4	35	27.5	42	20	44	27	36	102110.4
			102111.1	102111	28	1	38	30.5	48	25	47	36	41	102111.4
			102112.1	102112	35	1 1/4	45	34.5	57	25.5	56	41	50	102112.4
			102113.1	102113	42	1 1/2	51	40	61	26	63	50	60	102113.4
S	630	630	102114.1	102114	6	1/4	23	16	26	15	31	12	17	102114.4
			102115.1	102115	8	1/4	24	17	27	15	32	14	19	102115.4
			102116.1	102116	10	3/8	25	17.5	28	15	34	17	22	102116.4
			102117.1	102117	12	3/8	29	21.5	28	15	38	17	24	102117.4
			102118.1	102118	14	1/2	30	22	34	19.5	40	19	27	102118.4
			102119.1	102119	16	1/2	33	24.5	36	19.5	43	24	30	102119.4
	400	400	102120.1	102120	20	3/4	37	26.5	42	20	48	27	36	102120.4
			102121.1	102121	25	1	42	30	48	25	54	36	46	102121.4
			102122.1	102122	30	1 1/4	49	35.5	57	25.5	62	41	50	102122.4
			102123.1	102123	38	1 1/2	57	41	61	26	72	50	60	102123.4
L	315	315	102124.1	102124	6	1/4	21	14	26	15	29	12	14	102124.4
			102125.1	102125	8	1/8	21	14	24	10	29	12	17	102125.4
			102126.1	102126	8	3/8	23	16	28	15	31	17	17	102126.4
			102127.1	102127	8	1/2	26	19	34	19.5	34	19	17	102127.4
			102128.1	102128	10	1/8	22	15	24	10	30	14	19	102128.4
			102129.1	102129	10	3/8	24	17	28	15	32	17	19	102129.4
			102130.1	102130	10	1/2	27	20	34	19.5	35	19	19	102130.4
			102131.1	102131	12	1/4	24	17	28	15	32	17	22	102131.4
			102132.1	102132	12	1/2	27	20	34	19.5	35	19	22	102132.4
			102133.1	102133	15	3/8	28	21	33	15	36	19	27	102133.4
102134.1	102134	18	3/4	34	26.5	42	20	43	27	32	102134.4			
S	630	630	102135.1	102135	12	1/2	28	20.5	34	19.5	37	19	24	102135.4
			102136.1	102136	14	3/8	30	22	33	15	40	19	27	102136.4
			102137.1	102137	16	3/8	33	24.5	37	15	43	24	30	102137.4
	400	400	102138.1	102138	20	1/2	37	26.5	42	19.5	48	27	36	102138.4
			102139.1	102139	25	3/4	42	30	46	20	54	36	46	102139.4
			102140.1	102140	30	1	49	35.5	55	25	62	41	50	102140.4

Note: If you wish to order AISI 316 stainless steel fittings, please change the first two digits from 10.... to 11....
If you wish to order AISI 316 stainless steel fittings with AISI 304 stainless steel nuts, please change the first two digits from 10.... to 14....
Items not included in the ISO 8434-1 Norm.

Series DIN	10.... bar	11.... bar	Ordering Body	Ordering Equipped B3	Ø Tube	M	L1	L2	L3	L4	L5	CH1	CH2	Ordering Equipped B4
L	315	315	102204.1	102204	6	10x1	19	12	20	8	27	12	14	102204.4
			102205.1	102205	8	12x1.5	21	14	26	12	29	12	17	102205.4
			102206.1	102206	10	14x1.5	22	15	27	12	30	14	19	102206.4
			102207.1	102207	12	16x1.5	24	17	28	12	32	17	22	102207.4
			102208.1	102208	15	18x1.5	28	21	32	12	36	19	27	102208.4
			102209.1	102209	18	22x1.5	31	23.5	36	14	40	24	32	102209.4
S	630	630	102214.1	102214	6	12x1.5	23	16	26	12	31	12	17	102214.4
			102215.1	102215	8	14x1.5	24	17	27	12	32	14	19	102215.4
			102216.1	102216	10	16x1.5	25	17.5	28	12	34	17	22	102216.4
			102217.1	102217	12	18x1.5	29	21.5	28	12	38	17	24	102217.4
			102218.1	102218	14	20x1.5	30	22	32	14	40	19	27	102218.4
			102219.1	102219	16	22x1.5	33	24.5	32	14	43	24	30	102219.4

Note: If you wish to order AISI 316 stainless steel fittings, please change the first two digits from 10.... to 11....
If you wish to order AISI 316 stainless steel fittings with AISI 304 stainless steel nuts, please change the first two digits from 10.... to 14....
Items not included in the ISO 8434-1 Norm available on request only.