

**MOTORIDUTTORI E RIDUTTORI
A VITE SENZA FINE CHM**

**CHM WORM GEARED MOTORS
AND WORM GEAR UNITS**



POSIZIONE DI MONTAGGIO - MOUNTING POSITION

B3

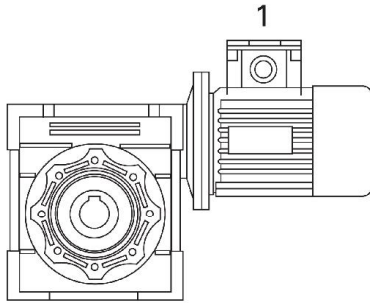

B6

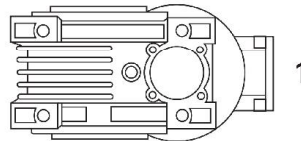

V5

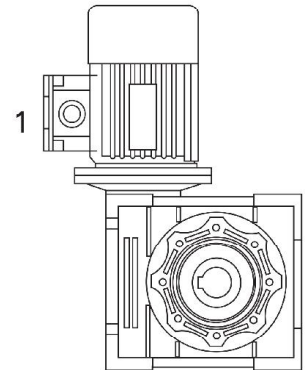

B7

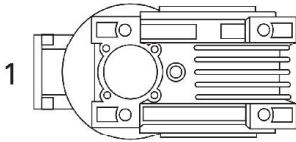

B8

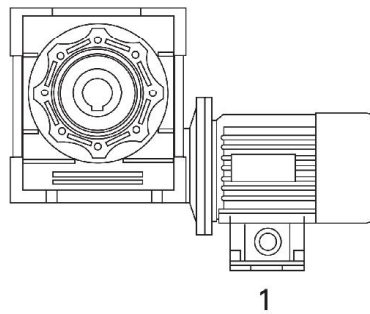

V6

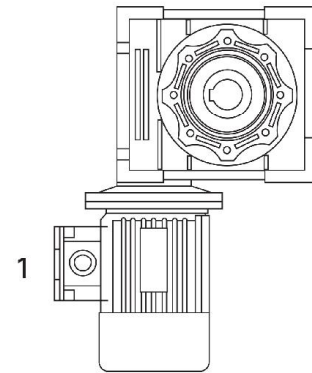

F...1

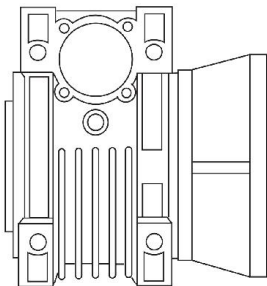

F...2

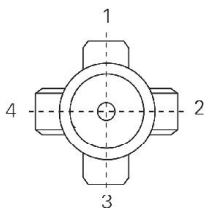
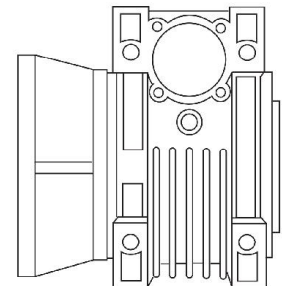

B3

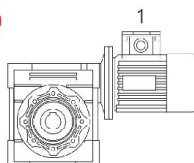

POSIZIONE MORSETTERIA

N.B. la posizione della morsetteria si riferisce sempre alla pos. B3

TERMINAL BOX POSITION

N.B. The position of the terminal box always refers to the B3 position.



CHM 050

| TIPO | i=ratio | n2 r/min | Kw=P1 | Nm=T2 | f.s. | Pred. attacco motore possibili | |
|------|---------|----------|-------|-------|------|-------------------------------------|---------|
| TYPE | i=ratio | n2 r/min | Kw=P1 | Nm=T2 | f.s. | Possible types of motor connections | |
| | 7.5 | 186.7 | 0.75 | 33.3 | 2.0 | 80/71 | B5/B14 |
| | 10 | 140.0 | 0.75 | 43.9 | 1.6 | 80/71 | B5/B14 |
| | 15 | 93.3 | 0.75 | 62.6 | 1.2 | 80/71 | B5/B14 |
| | 20 | 70.0 | 0.75 | 80 | 0.9 | 80/71 | B5/B14 |
| | 25 | 56.0 | 0.55 | 70 | 1.0 | 80/71 | B5/B14 |
| | 30 | 46.7 | 0.55 | 80 | 1.0 | 80/71 | B5/B14 |
| | 40 | 35.0 | 0.37 | 67 | 1.1 | 80/71/63 | B5/B14* |
| | 50 | 28.0 | 0.37 | 78 | 0.9 | 71/63 | B5/B14* |
| | 60 | 23.3 | 0.37 | 87 | 0.8 | 71/63 | B5/B14* |
| | 80 | 17.5 | 0.25 | 70 | 0.9 | 71/63 | B5/B14* |
| | 100 | 14.0 | 0.18 | 59 | 0.9 | 71/63 | B5/B14* |

* 63 solo - only B5

DIMENSIONI - DIMENSIONS

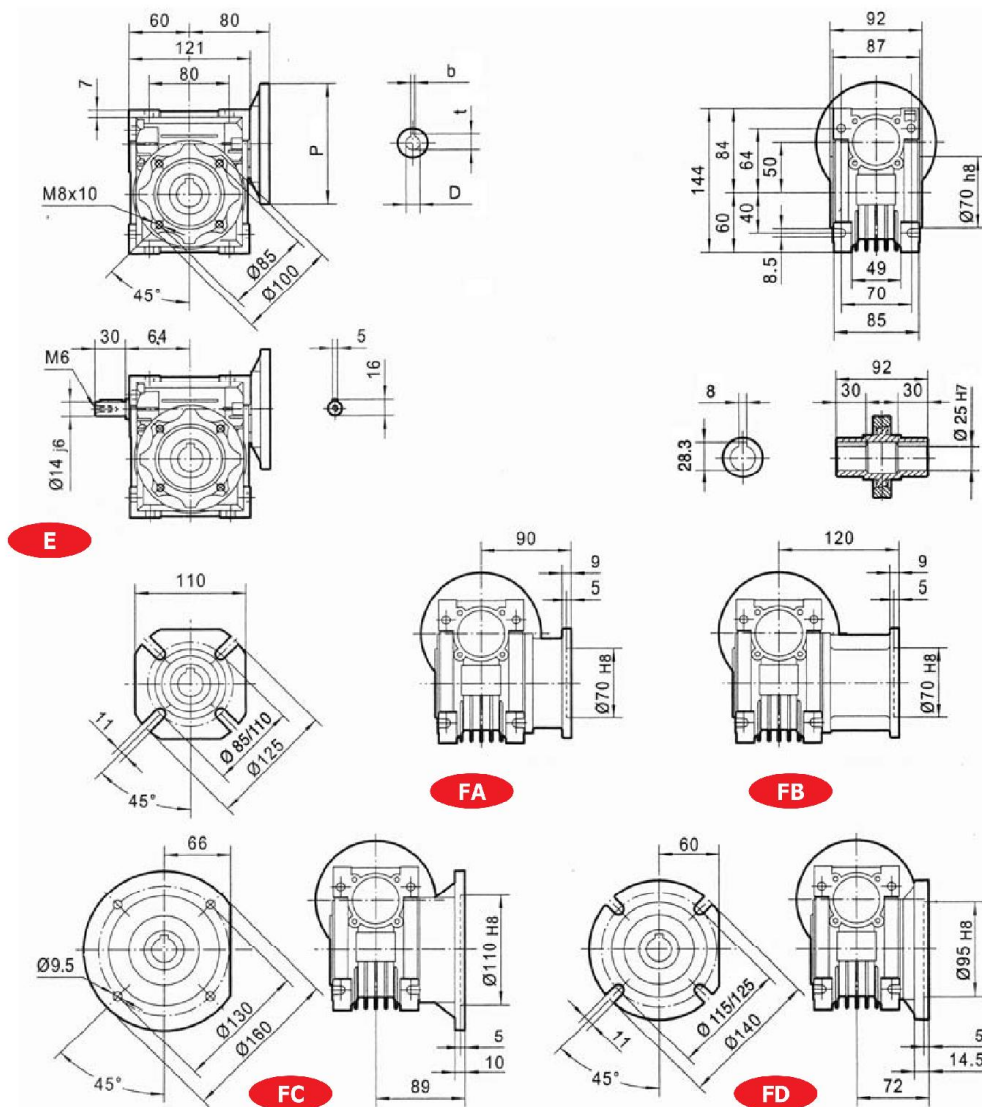

| PAM IEC | P | DE8 | b | t |
|---------|-----|-----|---|------|
| 80B5 | 200 | 19 | 6 | 21.8 |
| 71B5 | 160 | 14 | 5 | 16.3 |
| 63B5 | 140 | 11 | 4 | 12.8 |

| PAM IEC | P | DE8 | b | t |
|---------|-----|-----|---|------|
| 80B14 | 120 | 19 | 6 | 21.8 |
| 71B14 | 105 | 14 | 5 | 16.3 |

Peso Kg 3.5 senza motore
Weight 3.5 Kg excluding motor



| CHMR | 030 | 040 | 050 | 063 | 075 | 090 | 110 | 130 | 150 |
|--------------|------|------|-----|------|-----|-----|-----|-----|-----|
| A | 20 | 23 | 30 | 40 | 50 | 50 | 60 | 80 | 80 |
| D1 j6 | 9 | 11 | 14 | 19 | 24 | 24 | 28 | 30 | 35 |
| B2 | 51 | 60 | 74 | 90 | 105 | 125 | 142 | 162 | 195 |
| B3 | 45 | 53 | 64 | 75 | 90 | 108 | 135 | 155 | 175 |
| a | 30 | 40 | 50 | 63 | 75 | 90 | 110 | 130 | 150 |
| b1 | 3 | 4 | 5 | 6 | 8 | 8 | 8 | 8 | 10 |
| f1 | - | - | M6 | M6 | M8 | M8 | M10 | M10 | M12 |
| t1 | 10.2 | 12.5 | 16 | 21.5 | 27 | 27 | 31 | 33 | 38 |

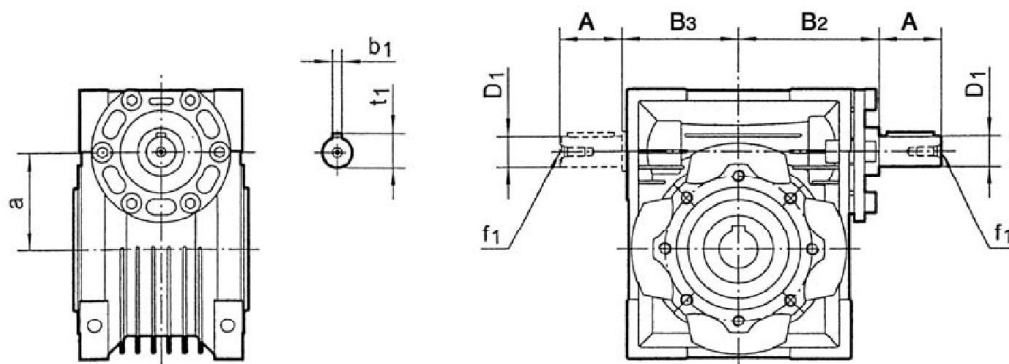

Per le dimensioni mancanti riferirsi al corrispondente CHM
 For the missing dimensions, please refer to the CHM correspondent



BRACCIO DI REAZIONE - TORQUE ARM

| TIPO - TYPE | I | R | F | H | Ø E | A | B | Ø C | Ø d | Ø P | N° | Peso cad kit kg Weight for kit kg |
|-------------|-----|----|------|----|-----|------|-------|-----|-----|-----|----|--------------------------------------|
| CHT MV 25* | 70 | 15 | 17.5 | 14 | 8 | 33.5 | 118.5 | 55 | 7 | 45 | 4 | 0.17 |
| CHT MV 30* | 85 | 15 | 24 | 14 | 8 | 38 | 138 | 65 | 7 | 55 | 8 | 0.18 |
| CHT MV 40 | 100 | 18 | 31.5 | 14 | 10 | 44 | 162 | 75 | 7 | 60 | 8 | 0.24 |
| CHT MV 50 | 100 | 18 | 38.5 | 14 | 10 | 50 | 168 | 85 | 9 | 70 | 8 | 0.27 |
| CHT MV 63 | 150 | 18 | 49 | 14 | 10 | 55 | 223 | 95 | 9 | 80 | 8 | 0.57 |
| CHT MV 75 | 200 | 30 | 47.5 | 25 | 20 | 70 | 300 | 115 | 9 | 95 | 8 | 1.10 |
| CHT MV 90 | 200 | 30 | 57.5 | 25 | 20 | 80 | 310 | 130 | 11 | 110 | 8 | 1.26 |
| CHT MV 110 | 250 | 35 | 62 | 30 | 25 | 100 | 385 | 165 | 11 | 130 | 8 | 1.92 |
| CHT MV 130 | 250 | 35 | 69 | 30 | 25 | 125 | 410 | 215 | 14 | 180 | 8 | 2.23 |
| CHT MV 150 | 250 | 35 | 84 | 30 | 25 | 125 | 410 | 215 | 14 | 180 | 8 | 2.23 |

* Privo di boccola antivibrante
* Without vibration resistant bushing

Il punto di ancoraggio del braccio di reazione è dotato di boccola antivibrante.

The anchoring point of the torque arm is equipped with a vibration resistant bushing.

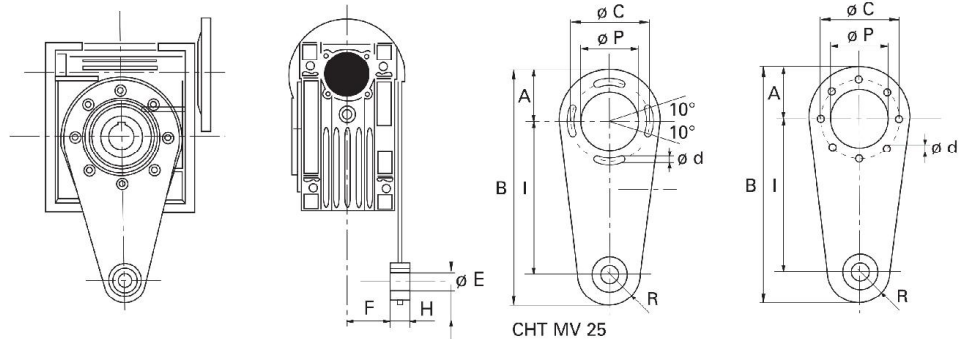

KIT ALBERO LENTO SEMPLICE - SINGLE OUTPUT SHAFT KIT

| TIPO - TYPE | A | Ø d | B | b | t 1 | T | L | d 2 | Peso cad kit kg Weight for kit kg |
|-------------|----|-----|------|----|------|-------|-----|--------|--------------------------------------|
| CHT MVS 25 | 23 | 11 | 25.5 | 4 | 12.5 | 55.5 | 81 | - | 0.07 |
| CHT MVS 30 | 30 | 14 | 32.5 | 5 | 16 | 69.5 | 102 | M6x16 | 0.14 |
| CHT MVS 40 | 40 | 18 | 43 | 6 | 20.5 | 85 | 128 | M6x16 | 0.27 |
| CHT MVS 50 | 50 | 25 | 53.5 | 8 | 28 | 99.5 | 153 | M10x22 | 0.60 |
| CHT MVS 63 | 50 | 25 | 53.5 | 8 | 28 | 119.5 | 173 | M10x22 | 0.67 |
| CHT MVS 75 | 60 | 28 | 63.5 | 8 | 31 | 128.5 | 192 | M10x22 | 0.94 |
| CHT MVS 90 | 80 | 35 | 84.5 | 10 | 38 | 149.5 | 234 | M12x28 | 1.79 |
| CHT MVS 110 | 80 | 42 | 84.5 | 12 | 45 | 164.5 | 249 | M16x35 | 2.70 |
| CHT MVS 130 | 80 | 45 | 85 | 14 | 48.5 | 180 | 265 | M16x35 | 3.60 |
| CHT MVS 150 | 82 | 50 | 87 | 14 | 53.5 | 210 | 297 | M16x35 | 5.00 |

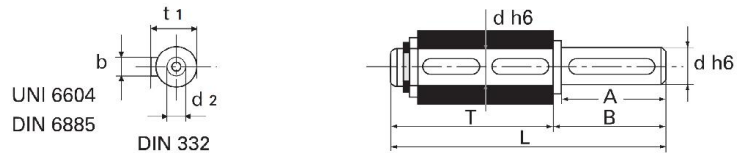

KIT ALBERO LENTO DOPPIO - DOUBLE OUTPUT SHAFT KIT

| TIPO - TYPE | A | Ø d | B | R | b | t 1 | L | d 2 | Peso cad kit kg Weight for kit kg |
|-------------|----|-----|------|-----|----|------|-----|--------|--------------------------------------|
| CHT MVD 25 | 23 | 11 | 25.5 | 50 | 4 | 12.5 | 101 | - | 0.11 |
| CHT MVD 30 | 30 | 14 | 32.5 | 63 | 5 | 16 | 128 | M6x16 | 0.16 |
| CHT MVD 40 | 40 | 18 | 43 | 78 | 6 | 20.5 | 164 | M6x16 | 0.34 |
| CHT MVD 50 | 50 | 25 | 53.5 | 92 | 8 | 28 | 199 | M10x22 | 0.75 |
| CHT MVD 63 | 50 | 25 | 53.5 | 112 | 8 | 28 | 219 | M10x22 | 0.84 |
| CHT MVD 75 | 60 | 28 | 63.5 | 120 | 8 | 31 | 247 | M10x22 | 1.20 |
| CHT MVD 90 | 80 | 35 | 84.5 | 140 | 10 | 38 | 309 | M12x28 | 2.50 |
| CHT MVD 110 | 80 | 42 | 84.5 | 155 | 12 | 45 | 324 | M16x35 | 3.44 |
| CHT MVD 130 | 80 | 45 | 85 | 170 | 14 | 48.5 | 340 | M16x35 | 4.25 |

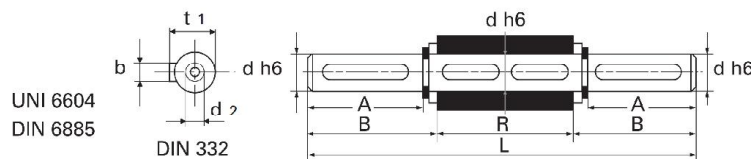



CHIARAVALLI[®]
GROUP *SpA*



**RIDUTTORI A VITE SENZA FINE
CON LIMITATORE DI COPPIA CHML**

**CHML WORM GEARBOXES
WITH TORQUE LIMITER**